

# STRASSER

Specifications:

**Montlake Linen Upper**  
24" wide, 48"h

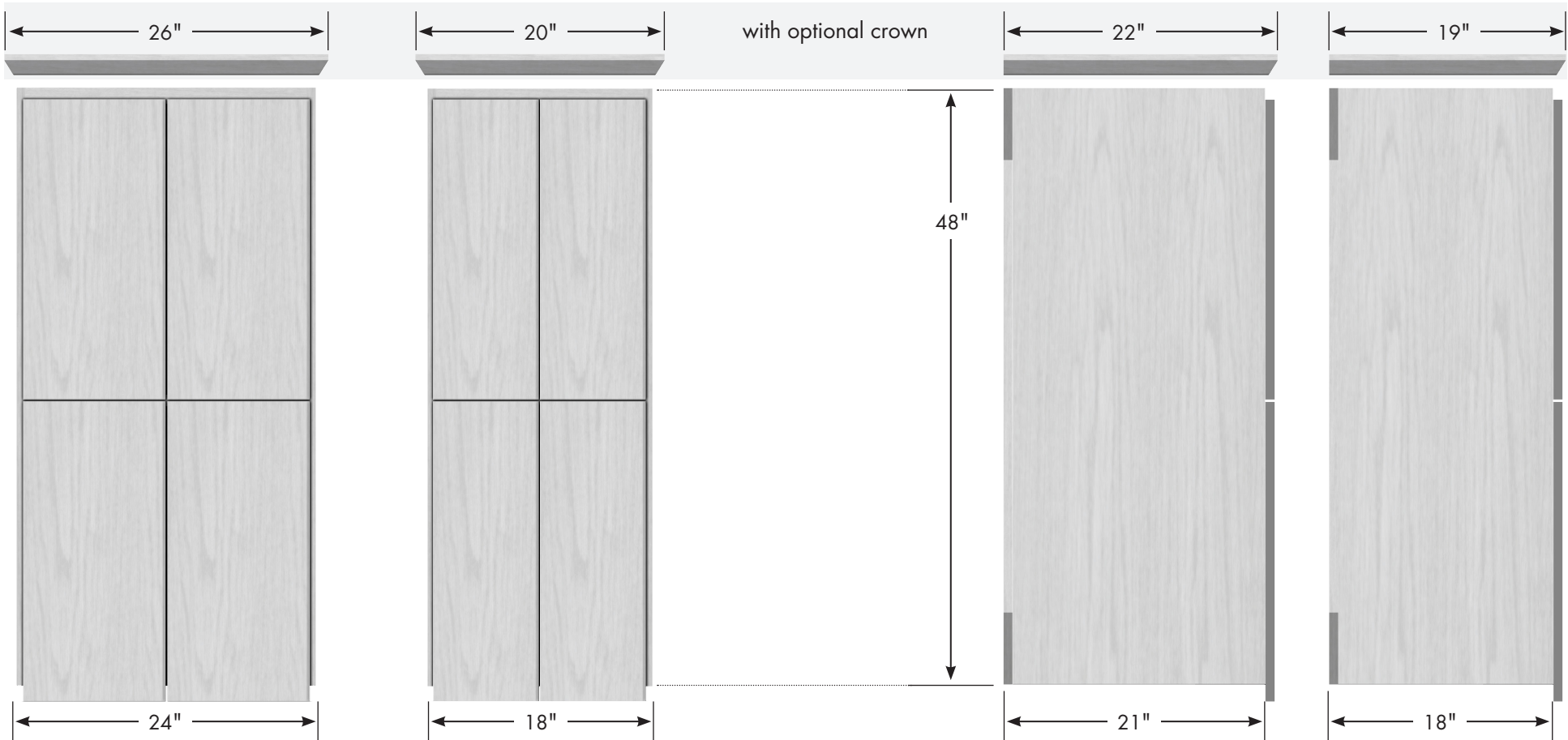

**24" Montlake Linen Upper**  
24" wide  
48" tall  
21" or 18" front-to-back  
optional crown adds 1" to height



**18" Montlake Linen Upper**  
18" wide  
48" tall  
21" or 18" front-to-back  
optional crown adds 1" to height



16

## SPECIAL NOTE

Serious or fatal crushing injuries can occur from a linen cabinet tipping over.

To help prevent tipover:

- Place heaviest items in the lower drawers
- Do not place heavy objects on top of this product
- Never allow children to climb or hang on drawers, doors or shelves
- Do not open more than one drawer at a time.

Units **MUST** be securely fastened to the wall.

- If you are not familiar with loads, holding materials, proper fastening devices/techniques; consult a professional.

Manufacturer assumes no liability for improper installation or excessive loads placed on screws, brackets or straps.