

STRASSER

Specifications:

Wallingford Vanity
30"w, 34½"h, drawers left

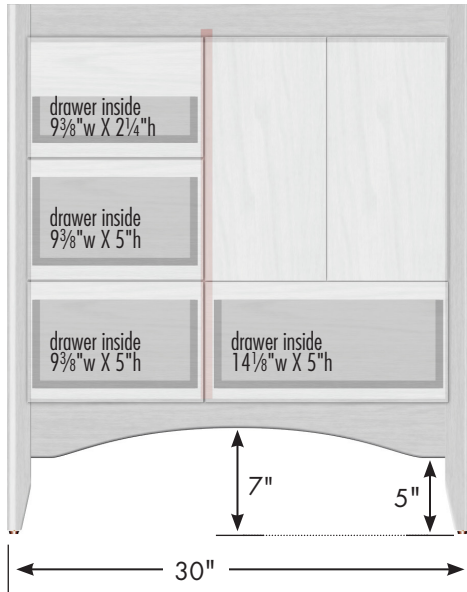
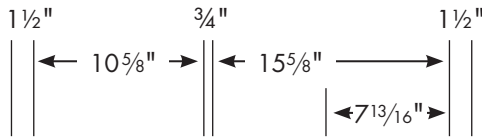

Adjustable/removable shelf under basin behind doors

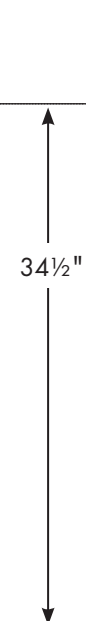

internal dividers

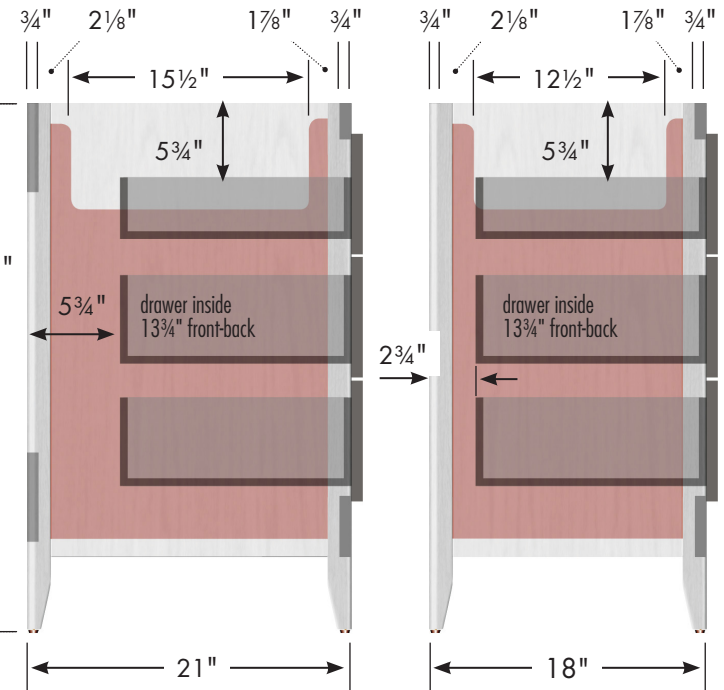

Vanity back clear openings for plumbing (may need to cut adjustable shelf)

30" Wallingford Vanity
Drawers Left
30" wide
34½" tall
21" or 18" front-to-back

