

## Specification Sheets for Traditional Medicine Cabinets

### SPECIFICATION VARIANCES

Dimensions on finished vanities may vary slightly from those shown on these specification sheets due to variability in construction materials.

Our products are engineered to maintain close dimensional tolerances but variability in manufacturing materials can change dimensions slightly (normally within  $\pm 1/8"$  but occasionally up to  $\pm 3/16"$ ).

In most applications these slight variations will have no impact upon installation, appearance or function. However, when planning and finishing a space for a built in vanity, **do not frame or finish the space before measuring the actual cabinet!**

We can not be responsible for any expenses incurred as a result of the end user or contractor not following this guideline.

REV: 2019-03

# STRASSER

Specifications:

## 48" & 36" Traditional Medicine Cabinets

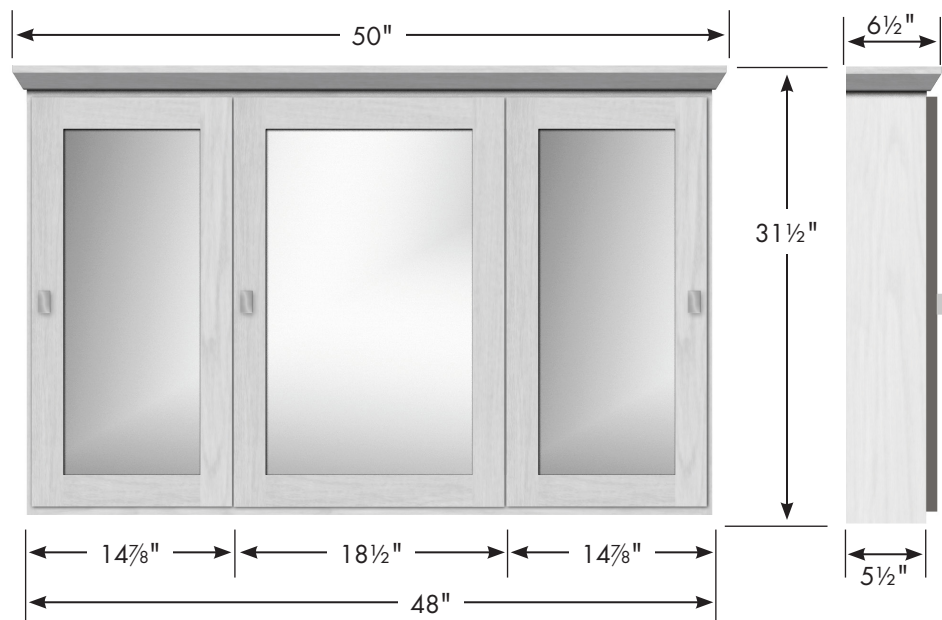

2 adjustable acrylic shelves each compartment (6 total).

### 48" Traditional Medicine Cabinet

48" wide  
31 1/2" tall  
5 1/2" front-to-back

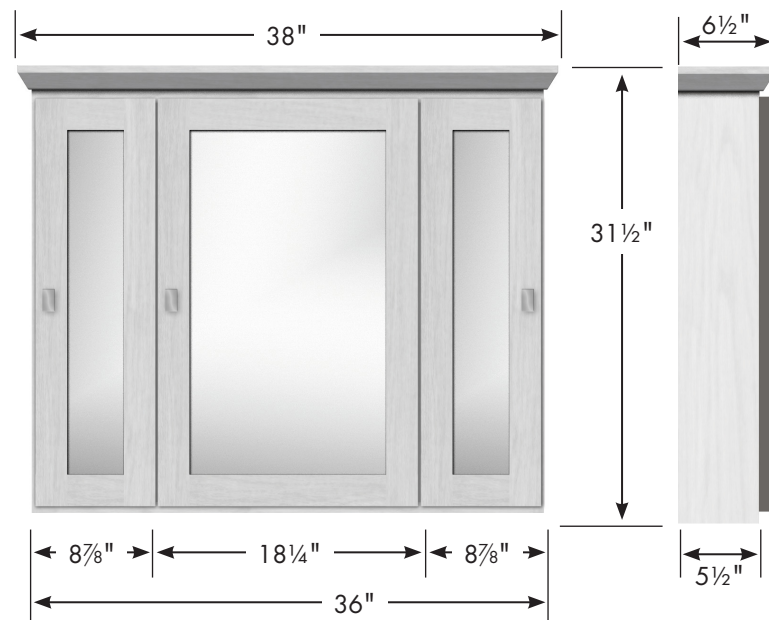

2 adjustable acrylic shelves each compartment (6 total).

### 36" Traditional Medicine Cabinet

36" wide  
31 1/2" tall  
5 1/2" front-to-back



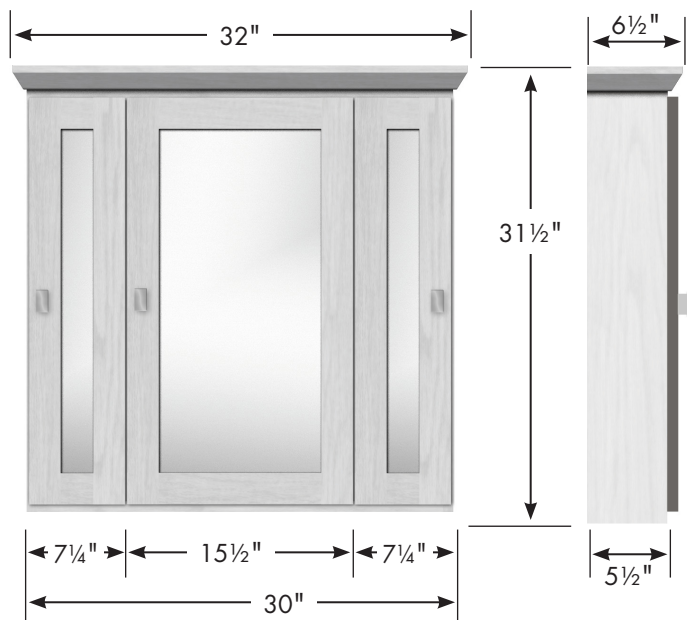

2 adjustable acrylic shelves each compartment (6 total).

### 30" Traditional Medicine Cabinet

30" wide  
31½" tall  
5½" front-to-back

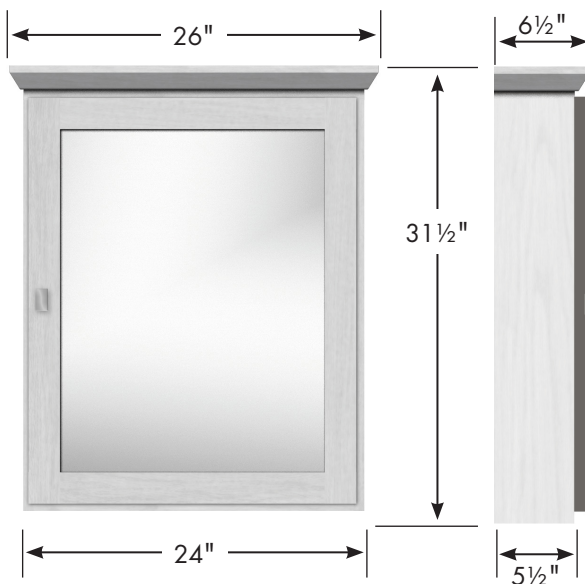

2 adjustable acrylic shelves

### 24" Traditional Medicine Cabinet

24" wide  
31½" tall  
5½" front-to-back

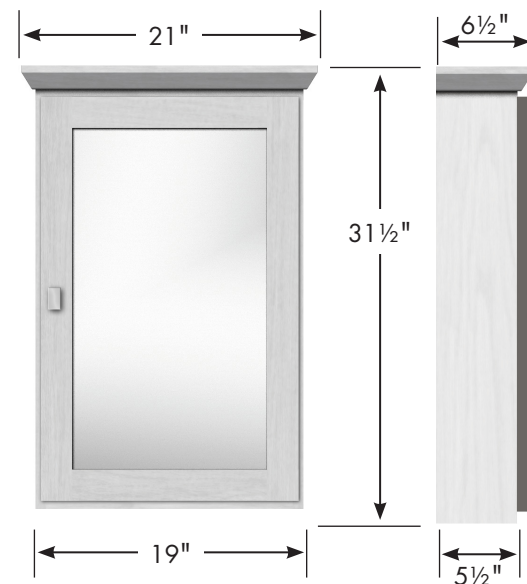

2 adjustable acrylic shelves

### 19" Traditional Medicine Cabinet

19" wide  
31½" tall  
5½" front-to-back



# STRASSER

Specifications:

20" & 15¼" Traditional Recessed  
Medicine Cabinets

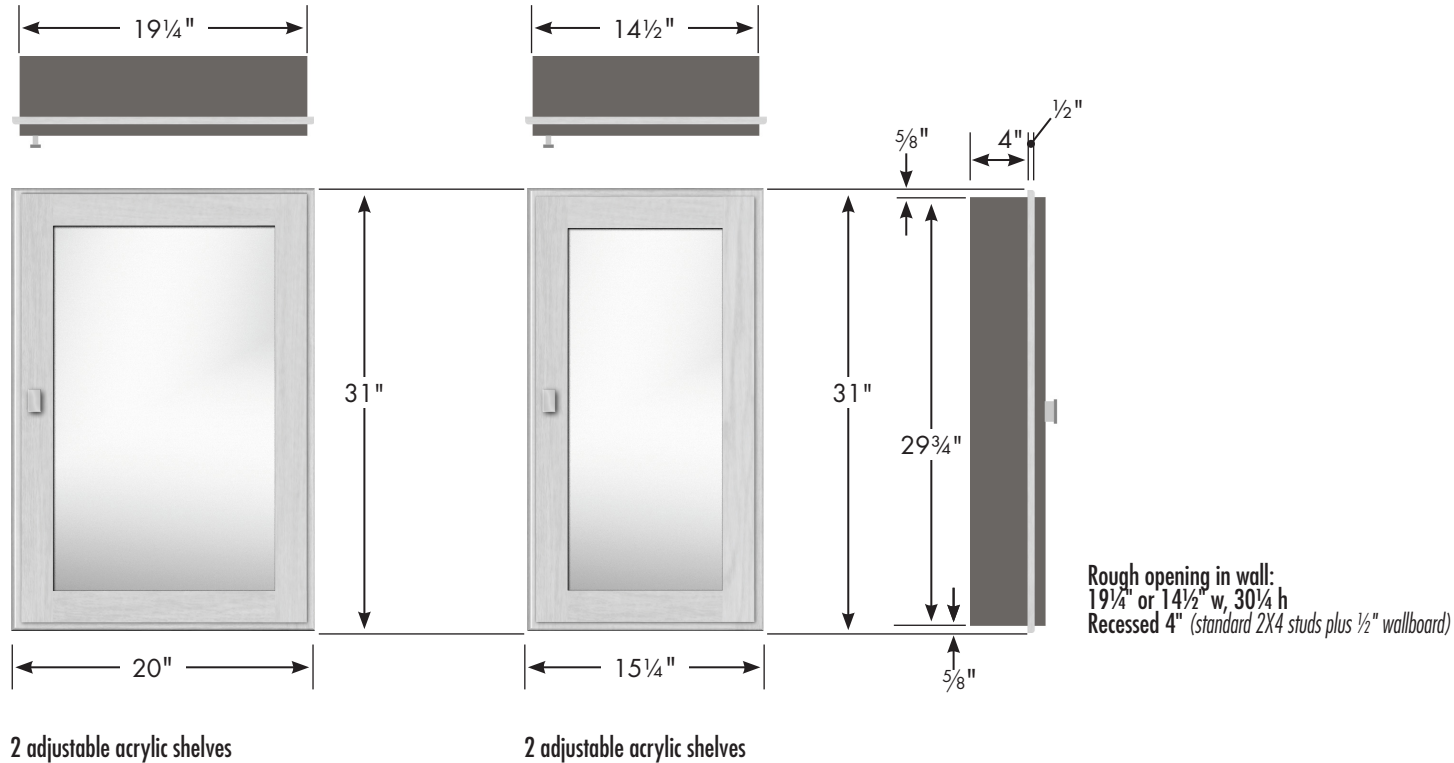

## 20" or 15¼" Traditional Recessed Medicine Cabinet

20" or 15¼" wide  
31" tall  
4½" front-to-back  
(4" recessed in wall)

